

Cut Sheet

Kurzweil MIDIBoard
Music Production Desk

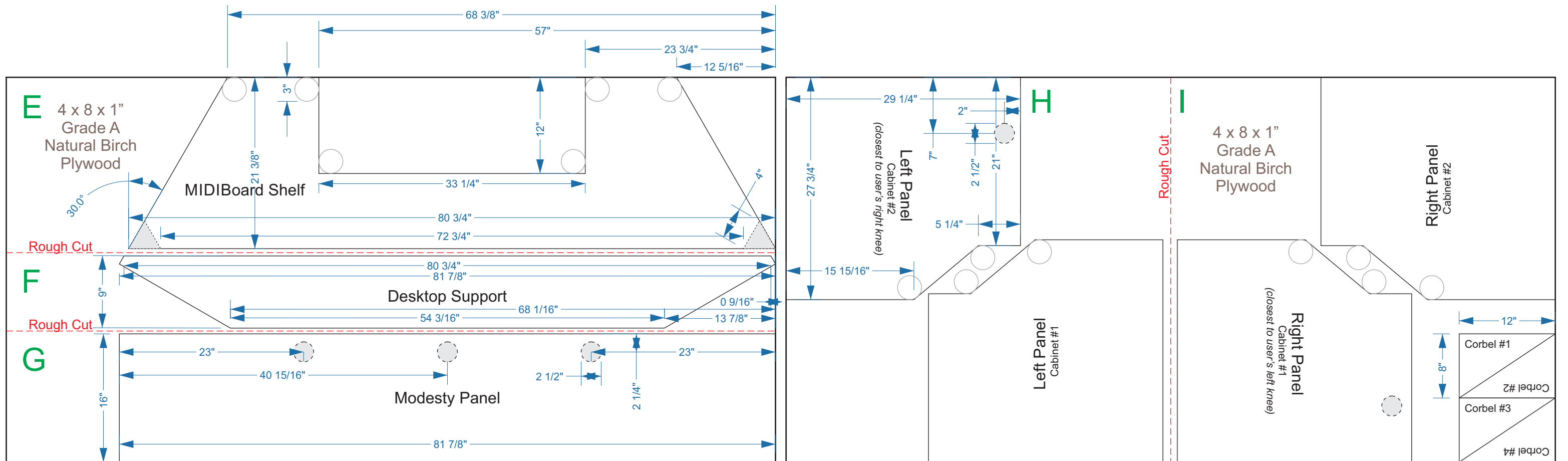

Other hardware & lumber requirements:

- 1" Birch edging tape (for MIDIBoard shelf)
- 1" Birch furring strips (or 1" thick Birch lumber, to be ripped)
- 3/4" (max) over-extension / over-travel, hold-out drawer slides (x2 pair)
- 1/2" x 1/2" x 27" hardwood (x4)
- Two butt joints employ triangular (equilateral) connecting blocks, measuring 4" per face and 17 1/4" tall. To make, tightly glue four layers of scrap 1" Birch plywood and cut to form (30°) on table saw.

Notes

- Rough cuts (red) facilitate handling on a small workbench / table saw
- Green letters A through I identify rough cut sheets
- All radius cuts are 1 1/2" (3" diameter)
- Rear Panels (D1 & D2) require an access hole or door. Dotted lines are a suggestion.
- Holes for cable runs (2 1/2" dia.) are suggestions and indicated by dotted lines.

